

# LEADING EDGE®

A Marley Engineered Products Brand

- Retail
- Food Service
- Refrigeration
- Commercial
- Sanitation/Fly Insect Control
- Light Industrial
- Heated Applications

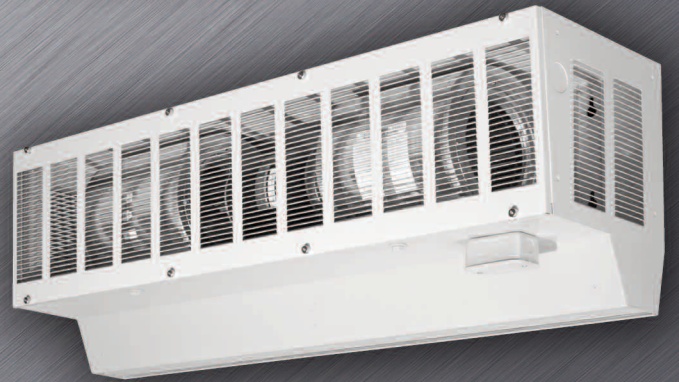

## AIR CURTAINS

# TYPICAL APPLICATIONS

## Retail



The compact low-profile series is designed for retail customer entrances, malls, stores and restaurants. This air curtain acts as a **Thermal Barrier** for mounting heights of 7 feet customer entrances and 8 feet interior doors.

## Commercial



Designed for supermarkets, schools, hospitals and other large facilities. This air curtain acts as a **Thermal Barrier** or **Interior Separation** device for mounting heights of 8-10 feet.

## Light Industrial

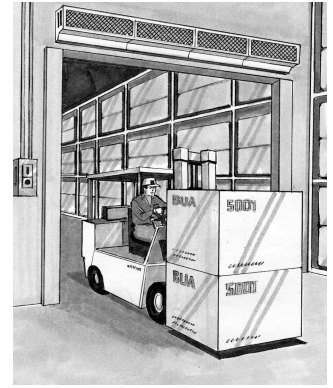

Designed for warehouses, manufacturing plants and other large facilities. This air curtain acts as a **Wind Resistance** or **Interior Separation** device for mounting heights of 10-14 feet.

### RETAIL APPLICATIONS Low-Profile Series

### COMMERCIAL APPLICATIONS Environmental Series

### LIGHT INDUSTRIAL APPLICATIONS High Velocity Series

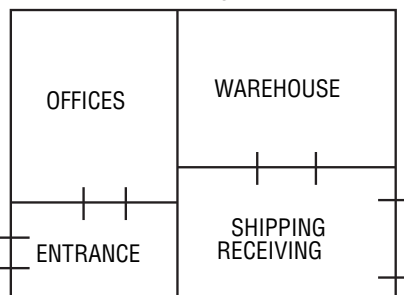
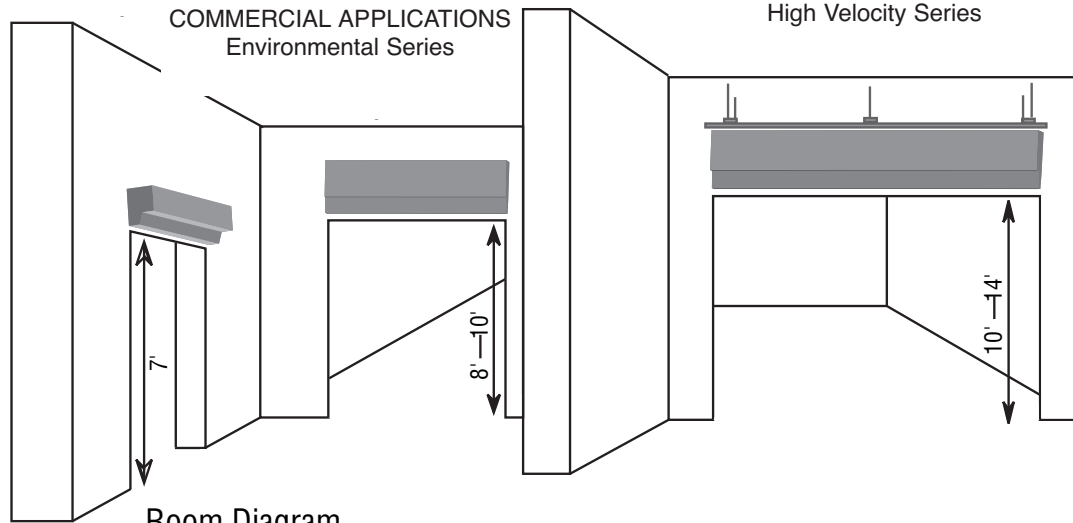

### Food Service



Designed for customer entrances (front door), and service entrances (rear door). This air curtain acts as a **Thermal Barrier** or **Fly and Insect Control** device for mounting heights of 7-8 feet.

### Drive-Thru Window



Designed specifically for drive-thru windows. This air curtain acts as a **Thermal Barrier** or **Fly and Insect Control** device for mounting heights up to 5 feet nozzle-to-counter.

### Refrigeration



Designed for freezers, coolers, cold storage facilities, processing plants and other refrigerated facilities. This air curtain acts as a **Thermal Barrier** for mounting heights of 7-12 feet.

### Sanitation



Designed for use in meat and poultry packing plants, processing plants and food preparation areas. This air curtain acts as a **Fly and Insect Control** device for mounting heights of 7-10 feet.

#### FOOD SERVICE APPLICATIONS Environmental Series

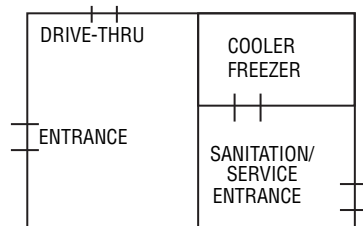
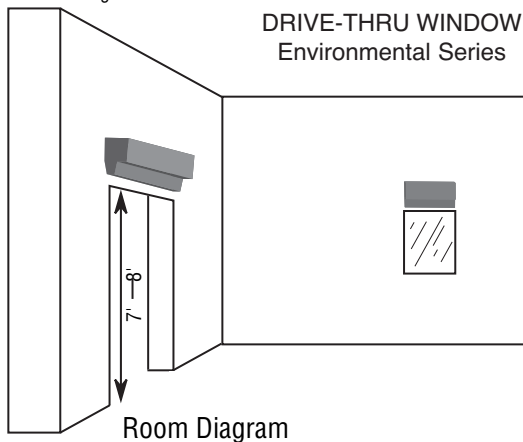

#### REFRIGERATION APPLICATIONS Environmental Series

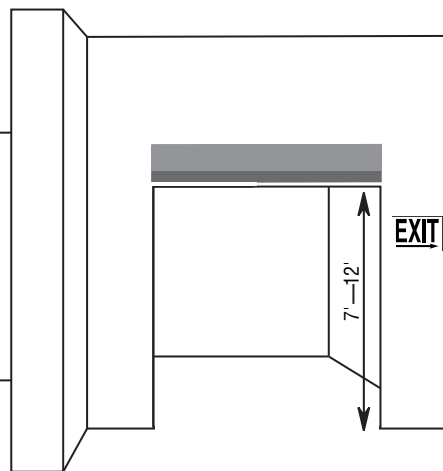

#### SANITATION APPLICATIONS Environmental Series

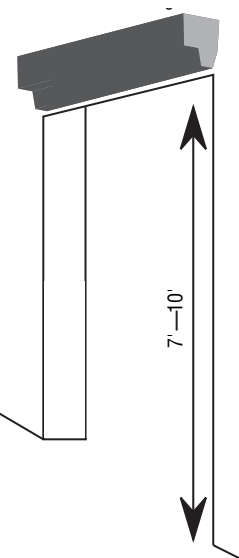

# INTRODUCTION TO AIR CURTAINS

For interactive selection guide, visit our website [www.marleymep.com](http://www.marleymep.com).

Air Curtains are used for a wide variety of applications from thermal barriers at shopping mall entrances, to fly and insect prevention at restaurant service doors, to factory freight doors for wind resistance and temperature separation. The air curtain enables traffic to flow unobstructed through openings while maintaining distinct environments, thus resulting in energy savings.

The most common type of air curtain is the horizontal, non-recirculating, single jet type. It will satisfy the majority of needs for commercial and industrial applications. The discharge velocity of the air curtain can range from 600 ft/min, for entranceways, to over 5,000 ft/min, for sealing environments from wind effects and insects.

| Applications by Door Height          | *Wind Conditions are Classified as Follows: |                      |        |        |                      |          |      |
|--------------------------------------|---|----------------------|--------|--------|----------------------|----------|------|
|                                      | Low Profile                                 | Environmental Series |        |        | High Velocity Series |          |      |
| Basic Motor HP / Series              | 1/8 HP                                      | 1/4 HP               | 1/2 HP | 3/4 HP | 1 HP                 | 1 1/2 HP | 3 HP |
| <b>RETAIL APPLICATIONS</b>           |   |                      |        |        |                      |          |      |
| <b>THERMAL BARRIER</b>               |   |                      |        |        |                      |          |      |
| 7' RETAIL ENTRANCE                   | ●   |                      |        |        |                      |          |      |
| <b>COMMERCIAL APPLICATIONS</b>       |   |                      |        |        |                      |          |      |
| <b>INTERIOR SEPARATION</b>           |   |                      |        |        |                      |          |      |
| 8' INTERIOR                          |   | ●                    |        |        |                      |          |      |
| 10' INTERIOR                         |   |                      | ●      |        |                      |          |      |
| <b>THERMAL BARRIER</b>               |   |                      |        |        |                      |          |      |
| 8' EXTERIOR                          |   | ○                    | ■      | □      |                      |          |      |
| 10' EXTERIOR                         |   |                      | ○      | ■      |                      |          |      |
| <b>FOOD SERVICE APPLICATIONS</b>     |   |                      |        |        |                      |          |      |
| <b>THERMAL BARRIER</b>               |   |                      |        |        |                      |          |      |
| 7' CUSTOMER ENTRANCE                 |   | ○                    |        |        |                      |          |      |
| 8' CUSTOMER ENTRANCE                 |   | ○                    |        |        |                      |          |      |
| <b>FLY &amp; INSECT CONTROL</b>      |   |                      |        |        |                      |          |      |
| 7' SERVICE ENTRANCE                  |   |                      | ■      | □      |                      |          |      |
| 8' SERVICE ENTRANCE                  |   |                      | ○      | ■      |                      |          |      |
| <b>REFRIGERATION APPLICATIONS</b>    |   |                      |        |        |                      |          |      |
| <b>THERMAL BARRIER</b>               |   |                      |        |        |                      |          |      |
| 7' COOLER                            | ●   |                      |        |        |                      |          |      |
| 8' COOLER                            |   | ●                    |        |        |                      |          |      |
| 10' COOLER                           |   |                      | ●      |        |                      |          |      |
| 12' COOLER                           |   |                      |        | ●      |                      |          |      |
| 8' FREEZER                           |   |                      | ●      |        |                      |          |      |
| 10' FREEZER                          |   |                      |        | ●      |                      |          |      |
| 12' FREEZER                          |   |                      |        | ●      |                      |          |      |
| <b>SANITATION APPLICATIONS</b>       |   |                      |        |        |                      |          |      |
| <b>FLY &amp; INSECT CONTROL</b>      |   |                      |        |        |                      |          |      |
| 8' EXTERIOR                          |   |                      |        | ■      | □                    | ◇        |      |
| 10' EXTERIOR                         |   |                      |        |        | ■                    | □        |      |
| <b>LIGHT INDUSTRIAL APPLICATIONS</b> |   |                      |        |        |                      |          |      |
| <b>INTERIOR SEPARATION</b>           |   |                      |        |        |                      |          |      |
| 12' INTERIOR OPENING                 |   |                      |        |        | ○                    |          |      |
| 14' INTERIOR OPENING                 |   |                      |        |        |                      | ○        |      |
| <b>WIND RESISTANCE</b>               |   |                      |        |        |                      |          |      |
| 10' EXTERIOR DOORWAY                 |   |                      |        |        | ■                    | □        | ◇    |
| 12' EXTERIOR DOORWAY                 |   |                      |        |        |                      | ○        | ■    |
| 14' EXTERIOR DOORWAY                 |   |                      |        |        |                      |          | ○    |

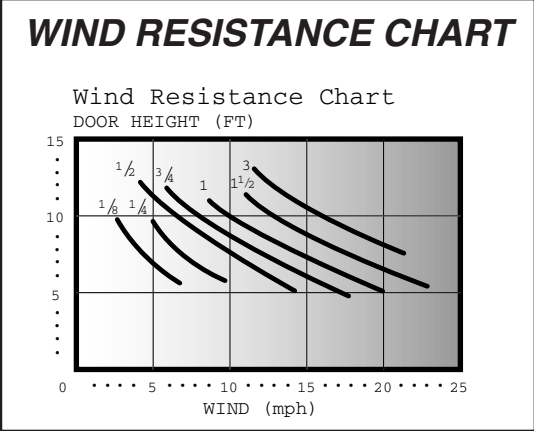

\* Guide does not include negative pressures or wind tunnel conditions. Wind resistance values are for normal applications.

# LOW PROFILE SERIES AIR CURTAINS



## Low-Profile Architectural Series

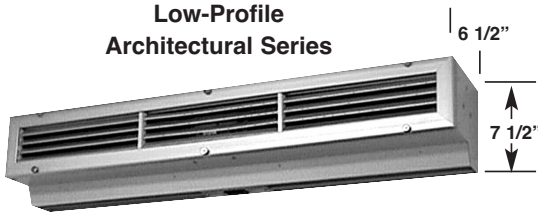

Featuring anodized aluminum architectural grill that compliments store interiors and public facilities.

- Create an “open door” atmosphere in retail establishments.
- For mounting heights of 7-feet, for exterior entrances or 8-feet interior doors.
- Reduce infiltration of exterior air, fumes, dust and dirt.
- Act as a temperature separation device, repelling outside air while maintaining interior environment.
- Patented design allows for continuous mounting.
- 7<sup>1</sup>/<sub>2</sub>” height designed for low ceiling applications with existing transom.
- Modern contemporary design with attractive, neutral beige finish.
- Galvanized corrosion-resistant cabinet and intake grills (**Standard line**).
- Pre-wired with 48-inch molded cord/plug assembly for easy installation.
- Two speed motor with convenient selector switch.
- Cross-flow blower wheels for maximum outlet uniformity.
- Adjustable air directional vanes.
- Selection Chart.



### Ordering Summary

| AIR DELIVERY @ NOZZLE OUTLET            |       |                    |                    |                     |              |                |                           |                               |  |
|---|-------|--------------------|--------------------|---------------------|--------------|----------------|---------------------------|-------------------------------|--|
| ORDER NUMBER                            | WIDTH | MAX VELOCITY (FPM) | AVG VELOCITY (FPM) | AIR FLOW RATE (CFM) | SOUND* LEVEL | # MOTORS @H.P. | INPUT POWER RATING** (kW) | APPROX. SHIPPING WEIGHT (LBS) |  |
| <b>Low Profile Models</b>               |       |                    |                    |                     |              |                |                           |                               |  |
| CLP48001#08RE                           | 48"   | 2000/1500          | 1800/1350          | 1350/1010           | 54           | 1@1/8          | 0.17                      | 37                            |  |
| CLP60001#25RE                           | 60"   | 2000/1500          | 1800/1350          | 1750/1315           | 54           | 1@1/4          | 0.31                      | 45                            |  |
| CLP96002#08RE                           | 96"   | 2000/1500          | 1800/1350          | 2700/2020           | 55           | 2@1/8          | 0.34                      | 74                            |  |
| <b>Low Profile Architectural Models</b> |       |                    |                    |                     |              |                |                           |                               |  |
| CLP48001#08RAS                          | 48"   | 2000/1500          | 1800/1350          | 1350/1010           | 54           | 1@1/8          | 0.17                      | 37                            |  |
| CLP60001#25RAS                          | 60"   | 2000/1500          | 1800/1350          | 1750/1315           | 54           | 1@1/4          | 0.31                      | 45                            |  |
| CLP96002#08RAS                          | 96"   | 2000/1500          | 1800/1350          | 2700/2020           | 55           | 2@1/8          | 0.34                      | 74                            |  |

\* Decibel reading on the “A” scale measured 10-feet from nozzle.

# - Indicate Voltage: 1=120/1, 2=220/1 (Note: 60” units only available in 120/1V) Unit operates on 50/60 cycle Hz.

\*\* Amp draw may be estimated as follows: 1-PH amps = (Power Rating \* 1000)/(Voltage)

## 24” DRIVE-THRU WINDOW UNIT

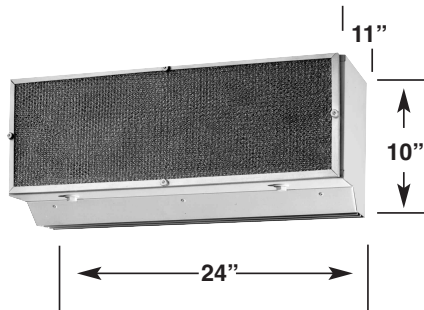

For use in restaurants, fast food windows, schools and drive-ins.

- Designed to provide protection against flies and insects, dust and odors. For service windows up to 30” wide with a maximum mounting height of 5 ft. nozzle-to-counter



### Ordering Summary

| MODEL NUMBER | ITEM DESCRIPTION         | MAX FPM AT NOZZLE | MAX CFM AT NOZZLE | MAX FPM 2' ABOVE COUNTER | H.P. | VOLTS | MAX AMPS | APPROX. SHIPPING WEIGHT |
|--------------|--------------------------|-------------------|-------------------|--------------------------|------|-------|----------|-------------------------|
| E24001115F   | With filter only.        | 3000              | 1600              | 750                      | 1/15 | 120   | 1.3      | 25 lbs.                 |
| E24001115G   | With intake grille only. | 3000              | 1600              | 750                      | 1/15 | 120   | 1.3      | 25 lbs.                 |
| E24001115FG  | With filter and grille.  | 3000              | 1600              | 750                      | 1/15 | 120   | 1.3      | 25 lbs.                 |

# ENVIRONMENTAL SERIES AIR CURTAINS



- Commercial - supermarkets, schools, hospitals
- Food Service - restaurants, bakeries, cafeterias
- Refrigeration - freezers, coolers, processing plants

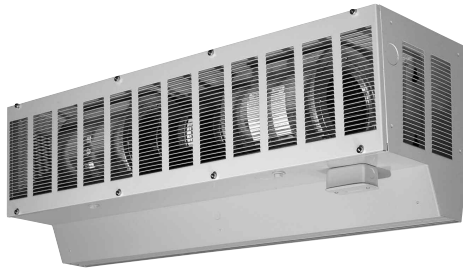

- Galvanized, corrosion-resistant, heavy duty steel cabinet.
- Easy access; no tools required for inspection and cleaning.
- Heavy duty, totally enclosed motors with permanently lubricated bearings.
- Electrically heated models available
- Hot Water/Steam Heated Models
- Exclusive Smart-Trac II Adjustable Mounting System (Pat. Pend.) allows for 6-way adjustment and alignment at the cabinet to compensate for possible overhead obstacles such as sprinkler pipes, conduit and beams. (Optional on all models).



## Ordering Summary

| AIR DELIVERY @ NOZZLE OUTLET |       |                            |                            |                                  |                 |                          |      |                               |
|------------------------------|-------|----------------------------|----------------------------|----------------------------------|-----------------|--------------------------|------|-------------------------------|
| MODEL NUMBER                 | WIDTH | MAX VELOCITY (FPM) HI/LOW† | AVG VELOCITY (FPM) HI/LOW† | AVG. AIR FLOW RATE (CFM) HI/LOW† | # MOTORS @ H.P. | INPUT POWER RATING (KW)* |      | APPROX. SHIPPING WEIGHT (LBS) |
|                              |       |                            |                            |                                  |                 | 1-PH                     | 3-PH |                               |
| <b>1/4 HP Models</b>         |       |                            |                            |                                  |                 |                          |      |                               |
| E36001#25                    | 36"   | 2500/1850                  | 2000/1480                  | 1620/1200                        | 1@1/4           | 0.41                     | 0.24 | 65                            |
| E38001#25                    | 38"   | 2500/1850                  | 1955/1450                  | 1670/1240                        | 1@1/4           | 0.41                     | 0.24 | 67                            |
| E42001#25                    | 42"   | 2500/1850                  | 1900/1410                  | 1795/1330                        | 1@1/4           | 0.41                     | 0.24 | 70                            |
| E48001#25                    | 48"   | 2500/1850                  | 1855/1375                  | 2000/1480                        | 1@1/4           | 0.41                     | 0.24 | 77                            |
| E60002#25                    | 60"   | 2500/1850                  | 2125/1575                  | 2880/2135                        | 2@1/4           | 0.82                     | 0.48 | 128                           |
| E72002#25                    | 72"   | 2500/1850                  | 2000/1480                  | 3240/2400                        | 2@1/4           | 0.82                     | 0.48 | 130                           |
| E76002#25                    | 76"   | 2500/1850                  | 1955/1450                  | 3340/2475                        | 2@1/4           | 0.82                     | 0.48 | 134                           |
| E84002#25                    | 84"   | 2500/1850                  | 1915/1420                  | 3620/2680                        | 2@1/4           | 0.82                     | 0.48 | 142                           |
| E96002#25                    | 96"   | 2500/1850                  | 1855/1375                  | 4000/2960                        | 2@1/4           | 0.82                     | 0.48 | 154                           |
| E10803#25                    | 108"  | 2500/1850                  | 2000/1480                  | 4860/3600                        | 3@1/4           | 1.23                     | 0.72 | 195                           |
| E12003#25                    | 120"  | 2500/1850                  | 1945/1440                  | 5240/3880                        | 3@1/4           | 1.23                     | 0.72 | 207                           |
| E13203#25                    | 132"  | 2500/1850                  | 1895/1405                  | 5620/4160                        | 3@1/4           | 1.23                     | 0.72 | 219                           |
| E14403#25                    | 144"  | 2500/1850                  | 1855/1375                  | 6000/4440                        | 3@1/4           | 1.23                     | 0.72 | 231                           |
| <b>1/2 HP Models</b>         |       |                            |                            |                                  |                 |                          |      |                               |
| E36001#50                    | 36"   | 3800/2815                  | 3040/2250                  | 2460/1820                        | 1@1/2           | 0.62                     | 0.40 | 74                            |
| E38001#50                    | 38"   | 3800/2815                  | 2965/2195                  | 2535/1880                        | 1@1/2           | 0.62                     | 0.40 | 76                            |
| E42001#50                    | 42"   | 3800/2815                  | 2890/2140                  | 2730/2020                        | 1@1/2           | 0.62                     | 0.40 | 79                            |
| E48001#50                    | 48"   | 3800/2815                  | 2815/2085                  | 3040/2250                        | 1@1/2           | 0.62                     | 0.40 | 86                            |
| E60002#50                    | 60"   | 3800/2815                  | 3230/2390                  | 4375/3240                        | 2@1/2           | 1.25                     | 0.80 | 148                           |
| E72002#50                    | 72"   | 3800/2815                  | 3040/2250                  | 4920/3645                        | 2@1/2           | 1.25                     | 0.80 | 148                           |
| E76002#50                    | 76"   | 3800/2815                  | 2965/2195                  | 5070/3755                        | 2@1/2           | 1.25                     | 0.80 | 152                           |
| E84002#50                    | 84"   | 3800/2815                  | 2910/2155                  | 5500/4070                        | 2@1/2           | 1.25                     | 0.80 | 160                           |
| E96002#50                    | 96"   | 3800/2815                  | 2815/2085                  | 6080/4500                        | 2@1/2           | 1.25                     | 0.80 | 172                           |
| E10803#50                    | 108"  | 3800/2815                  | 3040/2250                  | 7380/5465                        | 3@1/2           | 1.87                     | 1.20 | 222                           |
| E12003#50                    | 120"  | 3800/2815                  | 2950/2184                  | 7960/5890                        | 3@1/2           | 1.87                     | 1.20 | 234                           |
| E13203#50                    | 132"  | 3800/2815                  | 2875/2130                  | 8540/6320                        | 3@1/2           | 1.87                     | 1.20 | 246                           |
| E14403#50                    | 144"  | 3800/2815                  | 2815/2085                  | 9120/6750                        | 3@1/2           | 1.87                     | 1.20 | 258                           |
| <b>3/4 HP Models</b>         |       |                            |                            |                                  |                 |                          |      |                               |
| E36001#75                    | 36"   | 4850/3590                  | 3880/2875                  | 3140/2325                        | 1@3/4           | 0.94                     | 1.20 | 83                            |
| E38001#75                    | 38"   | 4850/3590                  | 3790/2805                  | 3240/2400                        | 1@3/4           | 0.94                     | 1.20 | 86                            |
| E42001#75                    | 42"   | 4850/3590                  | 3685/2730                  | 3480/2575                        | 1@3/4           | 0.94                     | 1.20 | 89                            |
| E48001#75                    | 48"   | 4850/3590                  | 3595/2660                  | 3880/2875                        | 1@3/4           | 0.94                     | 1.20 | 96                            |
| E60001#75                    | 60"   | 4850/3590                  | 3395/2510                  | 4580/3390                        | 1@3/4           | 1.87                     | 2.39 | 112                           |
| E72002#75                    | 72"   | 4850/3590                  | 3880/2875                  | 6280/4650                        | 2@3/4           | 1.87                     | 2.39 | 166                           |
| E76002#75                    | 76"   | 4850/3590                  | 3790/2805                  | 6480/4795                        | 2@3/4           | 1.87                     | 2.39 | 172                           |
| E84002#75                    | 84"   | 4850/3590                  | 3715/2750                  | 7020/5195                        | 2@3/4           | 1.87                     | 2.39 | 179                           |
| E96002#75                    | 96"   | 4850/3590                  | 3595/2660                  | 7760/5745                        | 2@3/4           | 1.87                     | 2.39 | 192                           |
| E10803#75                    | 108"  | 4850/3590                  | 3880/2875                  | 9420/6975                        | 3@3/4           | 2.81                     | 3.59 | 249                           |
| E12003#75                    | 120"  | 4850/3590                  | 3765/2790                  | 10160/7520                       | 3@3/4           | 2.81                     | 3.59 | 262                           |
| E13203#75                    | 132"  | 4850/3590                  | 3670/2720                  | 10900/8070                       | 3@3/4           | 2.81                     | 3.59 | 275                           |
| E14403#75                    | 144"  | 4850/3590                  | 3595/2660                  | 11640/8615                       | 3@3/4           | 2.81                     | 3.59 | 288                           |

# - Indicate Voltage: 1 = 120/1, 2 = 220/1, 3 = 208/3, 4 = 230/3, 5 = 460/3

\* - AMP Draw maybe Estimated as Follows: 1-ph =  $\frac{\text{Power Rating} \cdot 1000}{\text{Voltage}}$  ; 3-ph =  $\frac{\text{Power Rating} \cdot 1000}{\text{Voltage} \cdot 1.732}$

† - Low speed only available on 1-PH units

# 3-PHASE ENVIRONMENTAL ELECTRICALLY HEATED SERIES



### Applications:

For use in vestibules, lobbies, staging areas, reception areas, waiting rooms and other customer greeting areas.

Heated air curtains are not designed to hold 100% of incoming cold air, as the required air velocity generated would be uncomfortable to patrons. The incoming cold air is entrained in the warm curtain of air, thus maintaining comfort levels.

Heated units also reduce the wind chill effect of personnel walking through or standing near openings.

### Special Features:

- New modular designed cabinet allows 8 to 48 kilowatts of heating capacity, in lengths ranging from 36 to 144 inches.
- Large, easily accessible pre-wired control box is side mounted and features a hinged swing down access panel.
- Easily visible indicator lights on control panel alerts operator when power to the unit is on and when fan and heat are operating.
- Helical coil heating element modules are easily replaceable.
- Heating elements are thermally protected and include a pilot light feature.
- Hinged element control panel is located in front of nozzle and swings down for servicing.
- Air-flow safety sensor disables heating element in the event motor/blowers need servicing or are wired incorrectly.
- Use Wall-mounted 24-volt thermostat for temperature control. (Not Included)
- Can be operated with or without heat for winter and summer operation.
- Exclusive Smart-Trac II Adjustable Mounting System Optional on all models.



### Available in:

- Three phase 60Hz, 208 volt motor and heat.
- Three phase 60Hz, 240 / 208 volt motor and heat.
- Three phase 60Hz, 480 volt motor and heat.
- For additional models consult factory.

### Ordering Summary

| MODEL NUMBER         | AIR DELIVERY @ NOZZLE OUTLET |                    |                 |               |               |               | APPROX. SHIPPING WEIGHT (LBS) | # MOTORS @ HP |
|----------------------|------------------------------|--------------------|-----------------|---------------|---------------|---------------|-------------------------------|---------------|
|                      | NOZZLE WIDTH (IN)            | NUMBER OF CABINETS | CONTROL VOLTAGE | MAX VEL (FPM) | AVG VEL (FPM) | AIRFLOW (CFM) |                               |               |
| <b>1/2 HP Models</b> |                              |                    |                 |               |               |               |                               |               |
| E36++1#50HE          | 36                           | 1                  | 24              | 3800          | 3040          | 2460          | 93                            | 1 @ 1/2       |
| E42++1#50HE          | 42                           | 1                  | 24              | 3800          | 2890          | 2730          | 98                            | 1 @ 1/2       |
| E48++1#50HE          | 48                           | 1                  | 24              | 3800          | 2815          | 3040          | 105                           | 1 @ 1/2       |
| E60++1#50HE          | 60                           | 1                  | 24              | 3800          | 2740          | 3350          | 117                           | 1 @ 1/2       |
| E72++2#50HE          | 72                           | 2                  | 24              | 3800          | 3040          | 4920          | 177                           | 2 @ 1/2       |
| E84++2#50HE          | 84                           | 2                  | 24              | 3800          | 2910          | 5460          | 181                           | 2 @ 1/2       |
| E96++2#50HE          | 96                           | 2                  | 24              | 3800          | 2815          | 6080          | 189                           | 2 @ 1/2       |
| E108++3#50HE         | 108                          | 3                  | 24              | 3800          | 3040          | 7380          | 261                           | 3 @ 1/2       |
| E120++3#50HE         | 120                          | 3                  | 24              | 3800          | 2950          | 7920          | 273                           | 3 @ 1/2       |
| E132++3#50HE         | 132                          | 3                  | 24              | 3800          | 2875          | 8540          | 285                           | 3 @ 1/2       |
| E144++3#50HE         | 144                          | 3                  | 24              | 3800          | 2815          | 9120          | 297                           | 3 @ 1/2       |
| <b>3/4 HP Models</b> |                              |                    |                 |               |               |               |                               |               |
| E42++1#75HE          | 42                           | 1                  | 24              | 4850          | 3685          | 3480          | 108                           | 1 @ 3/4       |
| E48++1#75HE          | 48                           | 1                  | 24              | 4850          | 3595          | 3880          | 115                           | 1 @ 3/4       |
| E60++1#75HE          | 60                           | 1                  | 24              | 4850          | 3395          | 4580          | 131                           | 1 @ 3/4       |
| E72++2#75HE          | 72                           | 2                  | 24              | 4850          | 3880          | 6280          | 195                           | 2 @ 3/4       |
| E84++2#75HE          | 84                           | 2                  | 24              | 4850          | 3715          | 6960          | 208                           | 2 @ 3/4       |
| E96++2#75HE          | 96                           | 2                  | 24              | 4850          | 3595          | 7760          | 221                           | 2 @ 3/4       |
| E108++3#75HE         | 108                          | 3                  | 24              | 4850          | 3880          | 9420          | 288                           | 3 @ 3/4       |
| E120++3#75HE         | 120                          | 3                  | 24              | 4850          | 3765          | 10100         | 301                           | 3 @ 3/4       |
| E132++3#75HE         | 132                          | 3                  | 24              | 4850          | 3670          | 10900         | 314                           | 3 @ 3/4       |
| E144++3#75HE         | 144                          | 3                  | 24              | 4850          | 3595          | 11640         | 327                           | 3 @ 3/4       |

++ TOTAL HEATER KW AVAILABLE (SELECT FROM BELOW)

|            | KW | BTU/HR | KW | BTU/HR  | KW | BTU/HR  |
|------------|----|--------|----|---------|----|---------|
| 1- CABINET | 08 | 27,320 | 12 | 40,980  | 16 | 54,640  |
| 2- CABINET | 16 | 54,640 | 24 | 81,960  | 32 | 109,280 |
| 3- CABINET | 24 | 81,960 | 36 | 122,940 | 48 | 163,920 |

**NOTE:** Multiply listed wattage by .75 for actual 208V rating. Maximum 15 kilowatts per cabinet at 240V.

# - SELECT VOLTAGE: 3 = 208V 3-PH, 4 = 240V/208V 3-PH, 5 = 480V 3-PH.

Note: Stock Cabinet and Grille color is Neutral Gray. Other standard colors available on request include: Navajo White, Northern White, Black, Charcoal Gray, Aluminum, Statuary Bronze and Desert Tan.

# SINGLE PHASE ENVIRONMENTAL SERIES ELECTRICALLY HEATED



- For use in vestibules, lobbies, staging areas, reception areas, waiting rooms and other customer greeting areas.
- Heated air curtains are not designed to hold 100% of incoming cold air, as the required air velocity generated would be uncomfortable to patrons. The incoming cold air is entrained in the warm curtain of air, thus maintaining comfort levels.
- Heated units also reduce the wind chill effect of personnel walking through or standing near an opening.

- Heated units supplied with pre-wired heater control box for efficient installation.
- Wall-mounted 24-volt thermostat for temperature control.
- Multiple coil capacities for proper application requirements.
- Heater control panel mounts in front of nozzle, below grill.

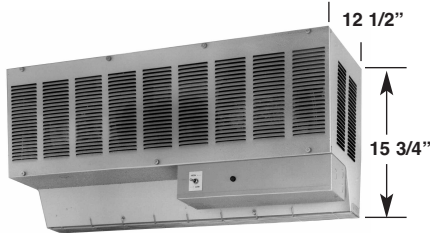

### Available In:

Single phase 60Hz, 120 volt motor, 240 volt heat.

### Ordering Summary

| MODEL NUMBER | WIDTH (IN) | HEATER |        | CONTROL VOLTAGE | MAX VEL (fpm) | AVG VEL (fpm) | AIRFLOW (cfm) | # MOTORS @HP |
|--------------|------------|--------|--------|-----------------|---------------|---------------|---------------|--------------|
|              |            | WATTS  | BUT/HR |                 |               |               |               |              |
| E36061125H   | 36         |        |        |                 | 2500          | 2000          | 1620          | 1 @ 1/4      |
| E42061125H   | 42         | 6,000  | 20,478 | 24              | 2500          | 1900          | 1795          | 1 @ 1/4      |
| E48061125H   | 48         |        |        |                 | 2500          | 1855          | 2000          | 1 @ 1/4      |
| E36091125H   | 36         |        |        |                 | 2500          | 2000          | 1620          | 1 @ 1/4      |
| E42091125H   | 42         | 9,000  | 30,717 | 24              | 2500          | 1900          | 1795          | 1 @ 1/4      |
| E48091125H   | 48         |        |        |                 | 2500          | 1855          | 2000          | 1 @ 1/4      |

# - Indicate Voltage: 1 = 120V-MTR/240V-HTR

## HOT WATER / STEAM HEATED

- For use in facilities with continuously open doors or which require supplemental perimeter heating.
- Provides an economical source of heat when steam or hot water is readily available
- Treats incoming air and prevents cold air from infiltrating large areas.
- Also used as supplemental heat when operated with door closed to provide additional perimeter heating.

- Unique universal construction method designed for both low-pressure steam or hot water applications.
- Premium quality coils provide superior heat transfer effectiveness for both low-pressure steam and hot water applications.
- Universal left- or right-hand opposite end connected coils.
- Single- or double-row coils available for desired capacity.
- Constructed of highly-effective 1/2-inch copper tubing with corrugated aluminum fins.

### Ordering Summary

| HOT WATER   |              |                |               |                |               | STEAM                                    |                |               |                |               |
|---|--------------|----------------|---------------|----------------|---------------|--|----------------|---------------|----------------|---------------|
| Based on 70°F entering air, 200°F entering water & 180° exiting water |              |                |               |                |               | Based on 5 psig steam, 70°F entering air |                |               |                |               |
| WIDTH* (IN)   | MODEL NO.    | ONE ROW        |               | TWO ROW        |               | MODEL NO.                                | ONE ROW        |               | TWO ROW        |               |
|   |              | CAPACITY (MBH) | TEMP RISE (F) | CAPACITY (MBH) | TEMP RISE (F) |  | CAPACITY (MBH) | TEMP RISE (F) | CAPACITY (MBH) | TEMP RISE (F) |
| <b>1/2 HP Models</b>  |              |                |               |                |               |  |                |               |                |               |
| 48  | E48001#50HW@ | 54.1           | 16.3          | 104            | 31.2          | E48001#50HS@                             | 81.6           | 24.7          | -              | -             |
| 60  | E60002#50HW@ | 77.4           | 16.2          | 149            | 31.1          | E60002#50HS@                             | 111            | 23.4          | -              | -             |
| 72  | E72002#50HW@ | 91.8           | 17.1          | 176            | 32.7          | E72002#50HS@                             | 128            | 24.1          | -              | -             |
| 84  | E84002#50HW@ | 106            | 17.6          | 203            | 33.7          | E84002#50HS@                             | 145            | 24.1          | -              | -             |
| 96  | E96002#50HW@ | 121            | 18.2          | 231            | 34.7          | E96002#50HS@                             | 164            | 24.8          | -              | -             |
| 108   | E10803#50HW@ | 134            | 16.6          | 267            | 33.0          | E10803#50HS@                             | 186            | 23.0          | -              | -             |
| 120   | E12003#50HW@ | 159            | 18.3          | 304            | 35.0          | E12003#50HS@                             | 210            | 24.3          | -              | -             |
| 132   | E13203#50HW@ | 173            | 18.5          | 331            | 35.4          | E13203#50HS@                             | 226            | 24.2          | -              | -             |
| 144   | E14403#50HW@ | 188            | 18.9          | 359            | 36.1          | E14403#50HS@                             | 244            | 24.7          | -              | -             |
| <b>3/4 HP Models</b>  |              |                |               |                |               |  |                |               |                |               |
| 48  | E48001#75HW@ | 63.2           | 14.9          | 122            | 28.7          | E48001#75HS@                             | 94.2           | 22.4          | 180            | 42.7          |
| 60  | E60002#75HW@ | 93.3           | 15.3          | 180            | 29.6          | E60002#75HS@                             | 131            | 21.7          | 251            | 41.5          |
| 72  | E72002#75HW@ | 107            | 15.6          | 207            | 30.1          | E72002#75HS@                             | 148            | 21.7          | 283            | 41.5          |
| 84  | E84002#75HW@ | 123            | 16.0          | 239            | 31.1          | E84002#75HS@                             | 168            | 21.8          | 321            | 41.7          |
| 96  | E96002#75HW@ | 142            | 16.7          | 272            | 32.1          | E96002#75HS@                             | 189            | 22.4          | 360            | 42.8          |
| 108   | E10803#75HW@ | 163            | 15.8          | 315            | 30.5          | E10803#75HS@                             | 215            | 20.8          | 410            | 39.8          |
| 120   | E12003#75HW@ | 187            | 16.8          | 359            | 31.5          | E12003#75HS@                             | 242            | 21.9          | 462            | 41.9          |
| 132   | E13203#75HW@ | 203            | 17.0          | 391            | 32.7          | E13203#75HS@                             | 261            | 21.9          | 499            | 41.8          |
| 144   | E14403#75HW@ | 221            | 17.4          | 424            | 32.5          | E14403#75HS@                             | 282            | 22.3          | 538            | 42.6          |

# - Indicate Voltage: 1 = 120/1, 2 = 200/1, 3 = /208/3, 4 = 230/3, 5 = 460/3; @ denote no. of rows

\* Add 12" for total unit width

▲ Hot Water/Steam units require 6 week lead time.



# HIGH VELOCITY SERIES



• For use in warehouses, manufacturing plants and other large facilities.

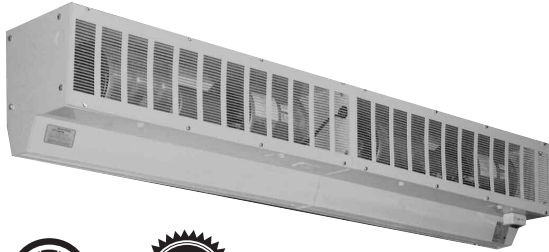

- Galvanized, corrosion-resistant cabinet and intake grill.
- Corrosion-resistant dual-intake scrolls.
- Precision-balanced twin stainless steel blower wheels.
- Exclusive *Smart-Trac II* Adjustable Mounting System (Pat. Pend.) allows for 6-way adjustment and alignment at the cabinet to compensate for possible overhead obstacles such as sprinkler pipes, conduit and beams.  
(Optional on all models).
- Steam and Hot Water heat available.



## Ordering Summary

| ORDER NUMBER             | WIDTH | AIR DELIVERY @ NOZZLE OUTLET |                    |                          | # MOTORS @ H.P. | INPUT POWER RATING (kW)*<br>3-ph | APPROX. SHIP-PIPING WEIGHT (LBS) |
|--------------------------|-------|------------------------------|--------------------|--------------------------|-----------------|----------------------------------|----------------------------------|
|                          |       | MAX VELOCITY (FPM)           | AVG VELOCITY (FPM) | AVG. AIR FLOW RATE (CFM) |                 |                                  |                                  |
| <b>1 H.P. Models</b>     |       |                              |                    |                          |                 |                                  |                                  |
| EL36001#00LI             | 36"   | 5250                         | 4200               | 3400                     | 1@1             | 1.20                             | 84                               |
| EL38001#00LI             | 38"   | 5250                         | 4095               | 3500                     | 1@1             | 1.20                             | 87                               |
| EL42001#00LI             | 42"   | 5250                         | 3990               | 3770                     | 1@1             | 1.20                             | 90                               |
| EL48001#00LI             | 48"   | 5250                         | 3890               | 4200                     | 1@1             | 1.20                             | 97                               |
| EL60001#00LI             | 60"   | 5250                         | 3675               | 4960                     | 1@1             | 2.39                             | 113                              |
| EL72002#00LI             | 72"   | 5250                         | 4200               | 6800                     | 2@1             | 2.39                             | 168                              |
| EL76002#00LI             | 76"   | 5250                         | 4095               | 7000                     | 2@1             | 2.39                             | 174                              |
| EL84002#00LI             | 84"   | 5250                         | 4025               | 7600                     | 2@1             | 2.39                             | 181                              |
| EL96002#00LI             | 96"   | 5250                         | 3890               | 8400                     | 2@1             | 2.39                             | 194                              |
| EL10803#00LI             | 108"  | 5250                         | 4200               | 10200                    | 3@1             | 3.59                             | 252                              |
| EL12003#00LI             | 120"  | 5250                         | 4075               | 11000                    | 3@1             | 3.59                             | 265                              |
| EL13203#00LI             | 132"  | 5250                         | 3975               | 11800                    | 3@1             | 3.59                             | 278                              |
| EL14403#00LI             | 144"  | 5250                         | 3890               | 12600                    | 3@1             | 3.59                             | 291                              |
| <b>1 1/2 H.P. Models</b> |       |                              |                    |                          |                 |                                  |                                  |
| EL36001#05LI             | 36"   | 5900                         | 4130               | 3345                     | 1@1 1/2         | 3.19                             | 80                               |
| EL38001#05LI             | 38"   | 5900                         | 4015               | 3430                     | 1@1 1/2         | 3.19                             | 82                               |
| EL42001#05LI             | 42"   | 5900                         | 3895               | 3680                     | 1@1 1/2         | 3.19                             | 88                               |
| EL48001#05LI             | 48"   | 5900                         | 3780               | 4080                     | 1@1 1/2         | 3.19                             | 92                               |
| EL60001#05LI             | 60"   | 5900                         | 3540               | 4780                     | 1@1 1/2         | 6.37                             | 108                              |
| EL72002#05LI             | 72"   | 5900                         | 4130               | 6690                     | 2@1 1/2         | 6.37                             | 160                              |
| EL76002#05LI             | 76"   | 5900                         | 4015               | 6860                     | 2@1 1/2         | 6.37                             | 164                              |
| EL84002#05LI             | 84"   | 5900                         | 3930               | 7425                     | 2@1 1/2         | 6.37                             | 172                              |
| EL96002#05LI             | 96"   | 5900                         | 3780               | 8160                     | 2@1 1/2         | 6.37                             | 184                              |
| EL10803#05LI             | 108"  | 5900                         | 4130               | 10035                    | 3@1 1/2         | 9.56                             | 240                              |
| EL12003#05LI             | 120"  | 5900                         | 3990               | 10770                    | 3@1 1/2         | 9.56                             | 252                              |
| EL13203#05LI             | 132"  | 5900                         | 3875               | 11505                    | 3@1 1/2         | 9.56                             | 264                              |
| EL14403#05LI             | 144"  | 5900                         | 3780               | 12240                    | 3@1 1/2         | 9.56                             | 276                              |
| <b>3 H.P. Models</b>     |       |                              |                    |                          |                 |                                  |                                  |
| EL36001#30LI             | 36"   | 7200                         | 5040               | 4080                     | 1@3             | 1.51                             | 91                               |
| EL38001#30LI             | 38"   | 7200                         | 4905               | 4190                     | 1@3             | 1.51                             | 94                               |
| EL42001#30LI             | 42"   | 7200                         | 4760               | 4495                     | 1@3             | 1.51                             | 98                               |
| EL48001#30LI             | 48"   | 7200                         | 4615               | 4980                     | 1@3             | 1.51                             | 106                              |
| EL60001#30LI             | 60"   | 7200                         | 4320               | 5830                     | 1@3             | 3.03                             | 122                              |
| EL72002#30LI             | 72"   | 7200                         | 5040               | 8160                     | 2@3             | 3.03                             | 182                              |
| EL76002#30LI             | 76"   | 7200                         | 4905               | 8380                     | 2@3             | 3.03                             | 188                              |
| EL84002#30LI             | 84"   | 7200                         | 4795               | 9060                     | 2@3             | 3.03                             | 197                              |
| EL96002#30LI             | 96"   | 7200                         | 4615               | 9960                     | 2@3             | 3.03                             | 212                              |
| EL10803#30LI             | 108"  | 7200                         | 5040               | 12240                    | 3@3             | 4.54                             | 273                              |
| EL12003#30LI             | 120"  | 7200                         | 4870               | 13140                    | 3@3             | 4.54                             | 288                              |
| EL13203#30LI             | 132"  | 7200                         | 4730               | 14040                    | 3@3             | 4.54                             | 303                              |
| EL14403#30LI             | 144"  | 7200                         | 4615               | 14940                    | 3@3             | 4.54                             | 318                              |

# - Indicate Voltage: 3 = 208/3, 4 = 230/3, 5 = 460/3, 6 = 600/3

\* - AMP Draw maybe Estimated as Follows: 3 -ph =  $\frac{\text{Power Rating} \cdot 1000}{\text{Voltage} \cdot 1.732}$

# 3-PHASE HIGH VELOCITY ELECTRICALLY HEATED SERIES



## Applications:

For use in warehouses, manufacturing plants and other large facilities with continuously open doors or provide supplemental heat when operated with doors closed.

Heated air curtains are not designed to hold 100% of incoming cold air, as the required air velocity generated would be uncomfortable to patrons. The incoming cold air is entrained in the warm curtain of air, thus maintaining comfort levels.

Heated units also reduce the wind chill effect of personnel walking through or standing near openings.

## Special Features:

- New modular designed cabinet allows 8 to 48 kilowatts of heating capacity, in lengths ranging from 42 to 144 inches.
- Large, easily accessible pre-wired control box is side mounted and features a hinged swing down access panel.
- Easily visible indicator lights on control panel alerts operator when power to the unit is on and when fan and heat are operating.
- Helical coil heating element modules are easily replaceable.
- Heating elements are thermally protected and include a pilot light feature.
- Hinged element control panel is located in front of nozzle and swings down for servicing.
- Air-flow safety sensor disables heating element in the event motor/blowers need servicing or are wired incorrectly.
- Use Wall-mounted 24-volt thermostat for temperature control. (Not Included)
- Can be operated with or without heat for winter and summer operation.
- Exclusive Smart-Trac II Adjustable Mounting System Optional on all models.



## Available in:

- Three phase 60Hz, 208 volt motor and heat.
  - Three phase 60Hz, 240 / 208 volt motor and heat.
  - Three phase 60Hz, 480 volt motor and heat.
- For additional models consult factory.

| MODEL NUMBER       | NOZZLE WIDTH (IN) | NUMBER OF CABINETS | AIR DELIVERY @ NOZZLE OUTLET |               |               |               | APPROX. SHIPPING WEIGHT (LBS) | # MOTORS @ HP |
|--------------------|-------------------|--------------------|------------------------------|---------------|---------------|---------------|-------------------------------|---------------|
|                    |                   |                    | CONTROL VOLTAGE              | MAX VEL (FPM) | AVG VEL (FPM) | AIRFLOW (CFM) |                               |               |
| <b>1 HP Models</b> |                   |                    |                              |               |               |               |                               |               |
| E42++1#00HE        | 42                | 1                  | 24                           | 5250          | 3990          | 3770          | 109                           | 1 @ 1         |
| E48++1#00HE        | 48                | 1                  | 24                           | 5250          | 3890          | 4200          | 116                           | 1 @ 1         |
| E60++1#00HE        | 60                | 1                  | 24                           | 5250          | 3675          | 4960          | 132                           | 1 @ 1         |
| E72++2#00HE        | 72                | 2                  | 24                           | 5250          | 4200          | 6800          | 197                           | 2 @ 1         |
| E84++2#00HE        | 84                | 2                  | 24                           | 5250          | 3990          | 7540          | 210                           | 2 @ 1         |
| E96++2#00HE        | 96                | 2                  | 24                           | 5250          | 3890          | 8400          | 268                           | 2 @ 1         |
| E108++3#00HE       | 108               | 3                  | 24                           | 5250          | 4200          | 10200         | 291                           | 3 @ 1         |
| E120++3#00HE       | 120               | 3                  | 24                           | 5250          | 4075          | 10940         | 304                           | 3 @ 1         |
| E132++3#00HE       | 132               | 3                  | 24                           | 5250          | 3975          | 11800         | 317                           | 3 @ 1         |
| E144++3#00HE       | 144               | 3                  | 24                           | 5250          | 3890          | 12600         | 330                           | 3 @ 1         |
| <b>3 HP Models</b> |                   |                    |                              |               |               |               |                               |               |
| E42++1#30HE        | 42                | 1                  | 24                           | 7200          | 4760          | 4495          | 117                           | 1 @ 3         |
| E48++1#30HE        | 48                | 1                  | 24                           | 7200          | 4615          | 4980          | 125                           | 1 @ 3         |
| E60++1#30HE        | 60                | 1                  | 24                           | 7200          | 4320          | 5830          | 141                           | 1 @ 3         |
| E72++2#30HE        | 72                | 2                  | 24                           | 7200          | 5040          | 8160          | 211                           | 2 @ 3         |
| E84++2#30HE        | 84                | 2                  | 24                           | 7200          | 4760          | 8990          | 226                           | 2 @ 3         |
| E96++2#30HE        | 96                | 2                  | 24                           | 7200          | 4615          | 9960          | 241                           | 2 @ 3         |
| E108++3#30HE       | 108               | 3                  | 24                           | 7200          | 5040          | 12240         | 312                           | 3 @ 3         |
| E120++3#30HE       | 120               | 3                  | 24                           | 7200          | 4870          | 13070         | 327                           | 3 @ 3         |
| E132++3#30HE       | 132               | 3                  | 24                           | 7200          | 4730          | 14040         | 342                           | 3 @ 3         |
| E144++3#30HE       | 144               | 3                  | 24                           | 7200          | 4615          | 14940         | 357                           | 3 @ 3         |

++ TOTAL HEATER KW AVAILABLE (SELECT FROM BELOW)

|            | KW | BTU/HR | KW | BTU/HR  | KW | BTU/HR  |
|------------|----|--------|----|---------|----|---------|
| 1- CABINET | 08 | 27,320 | 12 | 40,980  | 16 | 54,640  |
| 2- CABINET | 16 | 54,640 | 24 | 81,960  | 32 | 109,280 |
| 3- CABINET | 24 | 81,960 | 36 | 122,940 | 48 | 163,920 |

NOTE: Multiply listed wattage by .75 for actual 208V rating. Maximum 15 kilowatts per cabinet at 240V.

# - SELECT VOLTAGE: 3 = 208V 3-PH, 4 = 240V/208V 3-PH, 5 = 480V 3-PH.

Note: Stock Cabinet and Grille color is Neutral Gray. Other standard colors available on request include: Navajo White, Northern White, Black, Charcoal Gray, Aluminum, Statuary Bronze and Desert Tan.

# HIGH VELOCITY SERIES - HOT WATER / STEAM HEATED ▲



- For use in facilities with continuously open doors or which require supplemental perimeter heating.



Featuring **HEATCRAFT®** Coils



- Provides an economical source of heat when steam or hot water is readily available.
- Treats incoming air and prevents cold air from infiltrating large areas.
- Also used as supplemental heat when operated with door closed to provide additional perimeter heating.
- Unique universal construction method designed for both low-pressure steam or hot water applications.
- Premium quality coils provide superior heat transfer effectiveness for both low-pressure steam and hot water applications.
- Universal left- or right-hand installation on all coils.
- Single- or double-row coils available for desired capacity.
- Constructed of highly-effective 1/2-inch copper tubing with corrugated aluminum fins.

## Ordering Summary

| WIDTH*                 | HOT WATER<br>Based on 70° F Entering Air,<br>200° F Entering Water & 180° F Leaving Water |                |               |                |               | STEAM<br>Based on 5 psig steam, 70° F Entering Air |                |               |                |               |
|------------------------|---|----------------|---------------|----------------|---------------|--|----------------|---------------|----------------|---------------|
|                        | BASE MODEL  | ONE ROW        |               | TWO ROW        |               | BASE MODEL   | ONE ROW        |               | TWO ROW        |               |
|                        |   | Capacity (MBH) | Temp Rise (F) | Capacity (MBH) | Temp Rise (F) |  | Capacity (MBH) | Temp Rise (F) | Capacity (MBH) | Temp Rise (F) |
| <b>1 HP Models</b>     |   |                |               |                |               |  |                |               |                |               |
| 48"                    | EL48001#00HW@   | 66.4           | 14.5          | 128            | 27.9          | EL48001#00HS@                                      | 98.5           | 21.6          | 189            | 41.4          |
| 60"                    | EL60001#00HW@   | 98.1           | 14.9          | 190            | 28.7          | EL60001#00HS@                                      | 137            | 20.9          | 263            | 40.2          |
| 72"                    | EL72002#00HW@   | 113            | 15.2          | 217            | 29.3          | EL72002#00HS@                                      | 154            | 20.9          | 296            | 40.1          |
| 84"                    | EL84002#00HW@   | 129            | 15.5          | 251            | 30.2          | EL84002#00HS@                                      | 175            | 21.0          | 336            | 40.4          |
| 96"                    | EL96002#00HW@   | 149            | 16.2          | 287            | 31.2          | EL96002#00HS@                                      | 197            | 21.6          | 378            | 41.4          |
| 108"                   | EL10803#00HW@   | 172            | 15.4          | 332            | 29.7          | EL10803#00HS@                                      | 224            | 20.0          | 430            | 38.5          |
| 120"                   | EL12003#00HW@   | 196            | 16.3          | 378            | 31.5          | EL12003#00HS@                                      | 252            | 21.2          | 484            | 40.6          |
| 132"                   | EL13203#00HW@   | 213            | 16.5          | 412            | 31.9          | EL13203#00HS@                                      | 272            | 21.1          | 523            | 40.5          |
| 144"                   | EL14403#00HW@   | 232            | 16.9          | 447            | 32.5          | EL14403#00HS@                                      | 294            | 21.5          | 564            | 41.2          |
| <b>1-1/2 HP Models</b> |   |                |               |                |               |  |                |               |                |               |
| 48"                    | EL48001#05HW@   | 65.2           | 14.6          | 126            | 28.2          | EL48001#05HS@                                      | 96.9           | 21.9          | 185            | 41.9          |
| 60"                    | EL60001#05HW@   | 97.6           | 14.9          | 188            | 28.8          | EL60001#05HS@                                      | 136            | 21            | 262            | 40.3          |
| 72"                    | EL72002#05HW@   | 112            | 15.3          | 215            | 29.4          | EL72002#05HS@                                      | 153            | 21.1          | 293            | 40.4          |
| 84"                    | EL84002#05HW@   | 128            | 15.8          | 247            | 30.4          | EL84002#05HS@                                      | 173            | 21.2          | 331            | 40.7          |
| 96"                    | EL96002#05HW@   | 146            | 16.4          | 281            | 31.5          | EL96002#05HS@                                      | 194            | 21.9          | 371            | 41.9          |
| 108"                   | EL10803#05HW@   | 169            | 15.4          | 326            | 29.7          | EL10803#05HS@                                      | 221            | 20.1          | 424            | 38.6          |
| 120"                   | EL12003#05HW@   | 194            | 16.5          | 373            | 31.7          | EL12003#05HS@                                      | 249            | 21.4          | 478            | 41.4          |
| 132"                   | EL13203#05HW@   | 210            | 16.7          | 405            | 32.2          | EL13203#05HS@                                      | 269            | 21.3          | 515            | 40.9          |
| 144"                   | EL14403#05HW@   | 228            | 17.1          | 439            | 32.8          | EL14403#05HS@                                      | 290            | 21.8          | 554            | 41.8          |
| <b>3 HP Models</b>     |   |                |               |                |               |  |                |               |                |               |
| 48"                    | EL48001#30HW@   | 73.6           | 13.5          | 143            | 26.2          | EL48001#30HS@                                      | 108            | 20            | 208            | 38.5          |
| 60"                    | EL60001#30HW@   | 110            | 13.8          | 214            | 26.8          | EL60001#30HS@                                      | 152            | 19.2          | 293            | 37            |
| 72"                    | EL72002#30HW@   | 126            | 14.1          | 244            | 27.4          | EL72002#30HS@                                      | 170            | 19.2          | 328            | 37.1          |
| 84"                    | EL84002#30HW@   | 143            | 14.4          | 278            | 28.0          | EL84002#30HS@                                      | 191            | 19.2          | 368            | 37.1          |
| 96"                    | EL96002#30HW@   | 162            | 15.4          | 314            | 29.7          | EL96002#30HS@                                      | 213            | 20.3          | 409            | 39            |
| 108"                   | EL10803#30HW@   | 188            | 14.0          | 368            | 27.5          | EL10803#30HS@                                      | 245            | 18.3          | 471            | 35.2          |
| 120"                   | EL12003#30HW@   | 219            | 15.3          | 424            | 29.6          | EL12003#30HS@                                      | 278            | 19.5          | 535            | 37.5          |
| 132"                   | EL13203#30HW@   | 238            | 15.5          | 461            | 30.0          | EL13203#30HS@                                      | 300            | 19.5          | 577            | 37.6          |
| 144"                   | EL14403#30HW@   | 259            | 15.8          | 500            | 30.6          | EL14403#30HS@                                      | 323            | 19.9          | 621            | 38.3          |

**NOTE:** #- Denotes Unit Voltage: 3 = 208/3, 4 = 230/3, 5 = 460/3, 6 = 600/3  
 @ - Indicates Number of Rows (1 or 2)

Standard coils are opposite ends connected. For pricing on same end connected coils, consult factory.

\*Add 12" for total unit width

▲ Hot Water/Steam units require 6 week lead time.

# ACCESSORIES AND CONTROLS

## Door Switches

For use with all air curtains for instant activation or de-activation of unit upon door opening or closing.

- Automatic switches available for all models.  
(Three-phase motors require a control panel. See below.)
- Plunger Style for hinged doors or Roller Style for sliding and track doors.

Note: not recommended for use with heated units.



**C1200R**  
20 AMP



### Ordering Summary

| MODEL  | STYLE          | VOLTAGE | MAX AMPS | SHIP WT. |
|--------|----------------|---------|----------|----------|
| C1200R | Plunger/Roller | 120     | 20       | 1 lb     |

## Control Panels For three-phase air curtains requiring instant on/off automatic switches

Control Panels contain a single contactor with one adjustable overload relay per motor, control transformer with fused primary and secondary to meet NEC requirements, Hand-Off-Auto selector switch and terminal strip for power wiring and remote door switch.

### MODEL BREAKDOWN

Use this example for ordering the proper control panel necessary for air curtain unit.

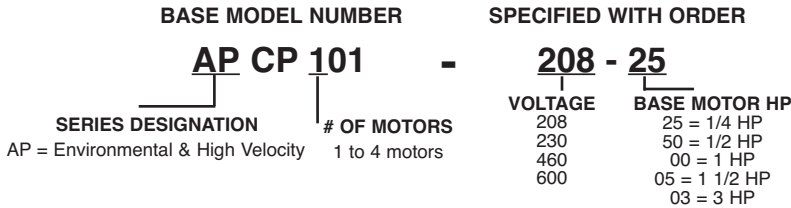

### Ordering Summary

| MODEL   | # OF MOTORS | SHIP WT. |
|---------|-------------|----------|
| APCP101 | 1           | 20 lbs   |
| APCP201 | 2           | 20 lbs   |
| APCP301 | 3           | 20 lbs   |
| APCP401 | 4           | 20 lbs   |

## Light Duty Brackets



| MODEL NUMBER | SET OF | SHIP WT. |
|--------------|--------|----------|
| ACWBL        | 2      | 10 lbs   |

## Medium Duty Brackets

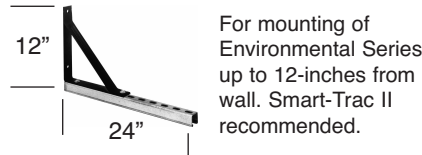

| MODEL NUMBER | SET OF | SHIP WT. |
|--------------|--------|----------|
| ACWBM2       | 2      | 52 lbs   |
| ACWBM3       | 3      | 78 lbs   |

## Heavy Duty Brackets



| MODEL NUMBER | SET OF | SHIP WT. |
|--------------|--------|----------|
| HVWB2        | 2      | 72 lbs   |
| HVWB3        | 3      | 98 lbs   |

## SMART TRAC II Adjustable Mounting System



- For use with suspension rod or wall mount applications.
- This unique mounting system is now available for Environmental and High Velocity Series air curtains

| MODEL NUMBER | SIZE | SHIP WT. |
|--------------|------|----------|
| ACSMTRK72    | 72"  | 50 lbs   |
| ACSMTRK84    | 84"  | 50 lbs   |
| ACSMTRK96    | 96"  | 60 lbs   |
| ACSMTRK108   | 108" | 65 lbs   |
| ACSMTRK120   | 120" | 70 lbs   |
| ACSMTRK132   | 132" | 75 lbs   |
| ACSMTRK144   | 144" | 80 lbs   |

## Filters

- For certain applications, such as food service or sanitation, filtering the air curtains intake may be desirable.
- Washable aluminum mesh filters for Low-Profile and Environmental Series air curtains.

S= Mounts on interior behind grille  
L= Exterior in place of grille

| MODEL NUMBER          | SIZE | SHIP WT. |
|-----------------------|------|----------|
| <b>24" Drive-Thru</b> |      |          |
| APF2400S              | 24"  | 1 lb     |
| APF2400L              | 24"  | 1 lb     |
| <b>Low-Profile</b>    |      |          |
| CLPF3600L             | 36"  | 1 lb     |
| CLPF4800L             | 48"  | 1 lb     |
| CLPF6000L             | 60"  | 1 lb     |
| <b>Environmental</b>  |      |          |
| APF3600S              | 36"  | 2 lbs    |
| APF3800S              | 38"  | 2 lbs    |
| APF4200S              | 42"  | 2 lbs    |
| APF4800S              | 48"  | 3 lbs    |
| APF6000S              | 60"  | 4 lbs    |
| APF3600L              | 36"  | 2 lbs    |
| APF3800L              | 38"  | 2 lbs    |
| APF4200L              | 42"  | 2 lbs    |
| APF4800L              | 48"  | 3 lbs    |
| APF6000L              | 60"  | 4 lbs    |

## Grilles

- Optional anodized aluminum architectural grille for Environmental and Low-Profile Series air curtains.

### Low-Profile

| MODEL NUMBER | SIZE | SHIP WT. |
|--------------|------|----------|
| CLPI036A     | 36"  | 4 lbs    |
| CLPI048A     | 48"  | 5 lbs    |

### Environmental

| MODEL NUMBER | SIZE | SHIP WT. |
|--------------|------|----------|
| API036A      | 36"  | 5 lbs    |
| API048A      | 48"  | 6 lbs    |
| API060A      | 60"  | 7 lbs    |

## Tamper Resistant Kit

- For use in schools, hospitals, correctional facilities or other locations prone to vandalism.
- Prevents unauthorized access to air curtain.
- Complete tool and hardware package provided.

| MODEL NUMBER | SHIP WT. |
|--------------|----------|
| ACTRK        | 2 lbs    |

All products manufactured by Marley Engineered Products are warranted against defects in workmanship and materials for one year from date of original installation or 18 months from date of manufacture, except where noted (see medal level) which are warranted against defects in workmanship and materials from date of installation. This warranty does not apply to damage from accident, misuse or alteration; nor where the connected voltage is more than 5% above the nameplate voltage; nor to equipment improperly installed or wired or maintained in violation of the product's installation instructions. All claims for warranty work must be accompanied by proof of the installation or purchase.

The customer shall be responsible for all costs incurred in the removal or reinstallation of products, including labor costs and shipping costs incurred to return products to Marley Engineered Products Service Center. Within the limitations of this warranty, inoperative units should be returned to the nearest Marley authorized service center or the Marley Engineered Products Service Center and we will repair or replace, at our option, at no charge to you with return freight paid by Marley. It is agreed that such repair or replacement is the exclusive remedy available from Marley Engineered Products. If the product requires replacement, but an identical model is no longer available, Marley Engineered Products will select a comparable item.

THE ABOVE WARRANTIES ARE IN LIEU OF ALL OTHER WARRANTIES EXPRESSED OR IMPLIED AND ALL IMPLIED WARRANTIES OF MERCHANTABILITY AND FITNESS FOR A PARTICULAR PURPOSE WHICH EXCEED THE AFORESAID EXPRESSED WARRANTIES ARE HEREBY DISCLAIMED AND EXCLUDED FROM THIS AGREEMENT. MARLEY ENGINEERED PRODUCTS SHALL NOT BE LIABLE FOR CONSEQUENTIAL DAMAGES ARISING WITH RESPECT TO THE PRODUCT, WHETHER BASED UPON NEGLIGENCE, TORT, STRICT LIABILITY OR CONTRACT.

Some states do not allow the exclusion or limitation of incidental or consequential damages, so the above exclusion or limitation may not apply to you. This warranty gives you specific legal rights and you may also have other rights which vary from state to state.

For the address of your nearest authorized service center, contact Marley Engineered Products in Bennettsville, SC, at 1-800-642-4328. Merchandise returned to the factory must be accompanied by a return authorization and service identification tag, both available from Marley Engineered Products. When requesting return authorization, include all numbers shown on the products.



**Disclaimer:** Marley Engineered Products has made a diligent effort to illustrate and describe the products in this literature accurately, however, such illustrations and descriptions are for the sole purpose of identification, and do not express or imply a warranty that the products are merchantable, or fit for a particular purpose, or that the products will necessarily conform to the illustrations or descriptions.

**Product Suitability:** Many states and localities have codes and regulations governing sales, construction, installation, and/or use of products for certain purposes, which may vary from those in neighboring areas. While Marley Engineered Products attempts to assure that its products comply with such codes, it cannot guarantee compliance, and cannot be responsible for how the product is installed or used. Before purchase and use of a product, please review the product application, and national and local codes and regulations, and be sure that the product, installation, and use will comply with them.







**Marley**  
Engineered Products  
An **SPX** Company

470 Beauty Spot Rd. East  
Bennettsville, SC 29512 USA

ZBL-LACBR

[www.marleymep.com](http://www.marleymep.com)